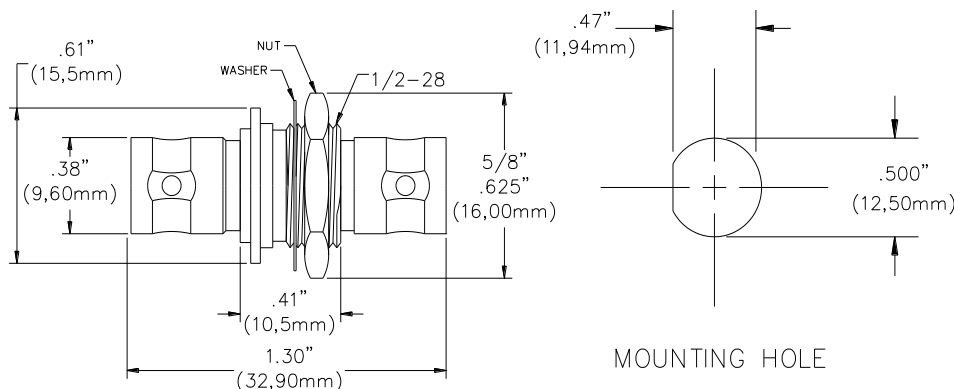

**Model 6705****Isolated BNC F-F Panel Connector for HDTV****Features**

- True 75 ohm impedance.
- Designed to meet the rigid standards for HDTV.
- Panel isolated with nickel plating.
- Connectors are precision machined (not die-cast) from brass.
- Insulator material is high density PTFE to maintain a perfect dielectric constant.
- Connectors utilize gold plated contact pin to maintain low return loss in high definition applications.

**Materials**

Connector Body:	Brass, Nickel Plated
Outer Contact:	Brass, Nickel Plated
Contact Pin (Female):	Brass, Gold Plated
Insulators:	PTFE

**Specifications**

Impedance:	75Ω
Frequency Range:	0 – 3 GHz
VSWR:	1.3 max
Insertion Loss:	0.2 db (@ 3 GHz)

Leakage Loss:	-55 db (@ 3 GHz)
Contact Resistance:	3 mΩ
Insulation Resistance:	5000 MΩ
Number of Insertions:	500 cycles minimum
Operating Temperature:	-40°C to +85°C (-40°F to +185°F)

**Ordering Information**

Model: **6705**  
HIGH DEF BNC ISOLATED PANEL CONNECTOR F/F

For CE compliance and for personal safety, do not hold in hand when voltages exceed 30 Vrms / 60 Vdc  
Maximum voltage for *hands free* use in controlled testing environments: 5000 Vrms Max.  
Do not use on circuits where transient stresses can exceed the rated voltage.

**USA:** Sales: 800-490-2361  
Technical Support: [technicalsupport@pomonatest.com](mailto:technicalsupport@pomonatest.com)  
Fax: 425-446-5844  
**Europe:** 31-(0) 40 2675 150 **International:** 425-446-5500  
**Where to Buy:** [www.pomonaelectronics.com](http://www.pomonaelectronics.com)

All dimensions are in inches. Tolerances (except noted): .xx = ±.02" (.51 mm), .xxx = ±.005" (.127 mm). All specifications are to the latest revisions.  
Specifications are subject to change without notice. Registered trademarks are the property of their respective companies.